

**Fire-Rated Infinity Door**

**20 Minute (Positive Pressure) Category A & B  
Manufacturing Specifications**

**As of May 2006**

<b>MAXIMUM SIZES</b>	<i>All doors shall have a minimum thickness of 1-3/4" ± 1/16"</i>
Single Swing:	<b>4/0 x 9/0</b>
Standard Pair:	<b>8/0 x 9/0 2, 3 and 4 point latch</b>
Double Egress Pair:	<b>8/0 x 9/0 2, 3 and 4 point latch</b>
Standard CVR Pair:	<b>8/0 x 9/0 *5" composition stile with 5" metal channel*</b>
Double Egress CVR Pair:	<b>8/0 x 9/0 *5" composition stile with 5" metal channel*</b>
Door & Transom Single Swing:	<b>4/0 x 9/0 Max Transom size = 4/0 x 3/4 transom bar between door &amp; transom</b>
Door & Transom Pair:	<b>N/A</b>
Dutch Door Single & Pair:	<b>N/A</b>

01

**MAXIMUM FIELD TRIM 1/4" WIDTH, 3/4" HEIGHT**

**Note:** *Hardware machining must be done by the factory or authorized dealer/distributor in order for the door to receive an attached metal label. See Prefit and Machining section.*

	<b>6/8</b>	<b>7/0</b>	<b>8/0</b>
ADD FOR 20 MINUTE CATEGORY A	\$ 124.00	\$ 134.00	\$ 144.00

006

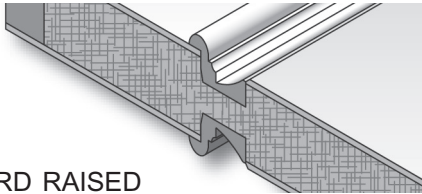

INFINITY  
STANDARD RAISED  
20 MIN. RATING

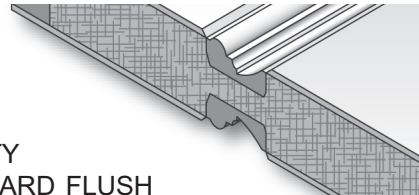

INFINITY  
STANDARD FLUSH  
20 MIN. RATING

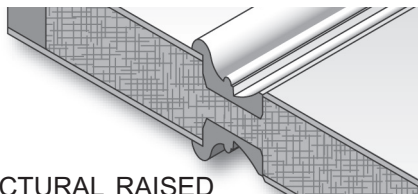

INFINITY  
ARCHITECTURAL RAISED  
20 MIN. RATING

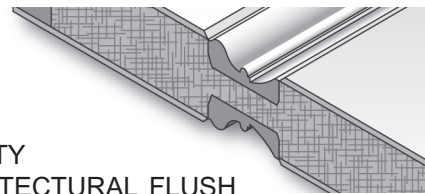

INFINITY  
ARCHITECTURAL FLUSH  
20 MIN. RATING

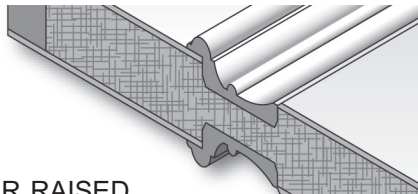

INFINITY  
DESIGNER RAISED  
20 MIN. RATING

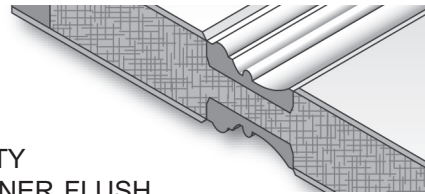

INFINITY  
DESIGNER FLUSH  
20 MIN. RATING



**Fire-Rated Infinity Door**

**20 Minute (Positive Pressure) Category A & B  
Machining Specifications  
As of May 2006**

Hardware Preparation:	<b>All hardware to be prepared for must be labeled and listed</b>
Hinges:	<b>Per NFPA 80, Table 2-8.1.1, continuous hinges, spring hinges</b>
Latch Sets:	<b>Positive latching is required on all fire doors. Roller latches are not allowed</b>
Cylindrical:	<b>Maximum 2-1/8 dia. hole with maximum 5" backset, minimum 2-3/8" backset</b>
Mortise:	<b>Maximum 1-1/16" wide x 5" deep x 6-1/2" high</b>
Fire Exit Devices:	<b>Rim, surface vertical rod, concealed vertical rod (CVR), CVR top only</b>
Closing Devices:	<b>Floor closers, surface mounted closers (must be mounted with through bolts) An exception to this would be when the doors have been ordered with interior blocking that would permit the closures to be attached with screws. Spring hinges (2 per leaf)</b>
Overhead Stops:	<b>Only with approved 20 minute rated hardware</b>
Concealed Closer Arms:	<b>Only with approved 20 minute rated hardware</b>
Louvers:	<b>Only with approved 20 minute rated louver kit</b>
Dust Boxes for Strike:	<b>Allowed (must be steel)</b>
Dead Bolts:	<b>Mortised minimum 5" from latch cutout, cylindrical minimum 5" CL to CL</b>
Interconnected Dead Bolts:	<b>Allowed</b>
Flush Bolts:	<b>Mortised automatic, mortised semi-automatic, surface mounted, extension to 24"</b>
Viewers:	<b>Maximum 1" dia.</b>
Metal Edges & Astragals:	<b>N/A *metal edges not allowed with intumescent* Supplied with all CVR construction: when metal edge is used, cat A is satisfied</b>
Protection Plates:	<b>Allowed up to 48" from bottom of door</b>
Automatic Door Bottoms:	<b>Surface, semi-mortised and fully-mortised allowed: Maximum cutout is 1" x 1-3/4"</b>
Von Duprin EPT Device:	<b>Allowed</b>
Raceways:	<b>Maximum 3/8" x 3/8" channel, minimum 1-1/8" from molding cutout</b>
Plant-Ons:	<b>One or both faces, maximum width = 2-3/8". Maximum thickness 3/4" Not closer than 3-1/2" from edge or hardware cutout, not more than 20% of door</b>
Vision Panels:	<b>1296 sq. in. glass, maximum width 36", maximum length 54". Minimum of 5-3/8" from edge of molding, door or hardware cutout. Larger vision panels are available when using listed approved vision lite frames and glass from specific manufacturers.</b>
Dutch Doors:	<b>N/A</b>
Door & Transom:	<b>Must be same construction as door. Transom may not be rabbetted. Install with a metal edge and astragal or with a transom bar between the door and transom Spring bolts must be applied as follows: 2" from each corner up to 18" tall require 2 per side; 18" to 36" tall require 3 per side; 36" to 40" require 4 per side</b>
Installation Instructions:	<b>Installation instructions must be supplied with all orders which are machined The instruction sheet must be securely attached to each pallet of doors</b>
Labeling:	<b>Warnock Hersey "ONLY" may be used. The labels must be applied 60" from the bottom of the door on the hinge side the only exception is when a "continuous hinge" is used then the label shall be applied to the top rail</b>
Secondary Labels:	<b>These are to be overlapped with the main label to indicate the following Fire exit hardware, surface mounted hardware, fire retardent edges, listed side panel, "S" label for positive pressure. (Continual improvements in fire testing)</b>